

Historic Estate

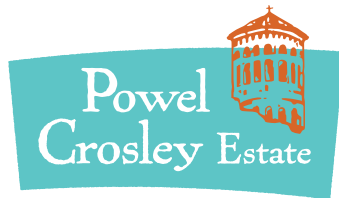

Powel Crosley Estate

This fantastic 1920's era mansion was built by the famed entrepreneur Powel Crosley, as a winter home for his wife, Gwendolyn, in 1929. The home featured many innovations for its time, including steel framed encased stone, embedded pipes and wiring and a 135 day construction schedule. Placed on the National Register of Historic Places in 1982, the estate was saved from commercial development and purchased by Manatee County, which operates it as a meeting space, conference and event venue.

The 21 room, two and a half story Mediterranean mansion boasts 11,000 sq. ft. of meeting space overlooking the scenic Sarasota Bay. Just a few minutes away from over 1,000 hotel rooms, numerous attractions, and dozens of restaurants, the Powel Crosley Estate offers beautiful scenery, ambiance and a yacht basin for charters, as well as an outdoor terrace and pavilion.

Conveniently located near the Sarasota Bradenton International Airport (SRQ), and next door to the Hilton Garden and minutes from the Holiday Inn Sarasota-Bradenton Airport, each hotel offers complimentary shuttle service to and from the hotel and the Powel Crosley Estate as well as the Sarasota Bradenton International Airport. This facility features the graceful styling and architecture of a bygone era yet includes all the modern amenities that make for a successful meeting experience!

Boat Basin Information & Nautical Directions

The boat basin is 7' deep at high tide. The dimensions of the basin are 50' wide and 100' long. Boats that are up to or under 52' can be docked as long as they don't have a large rudder. Boats with a large rudder must be under 47'.

Decimal Degrees:
Lat: 27.391292860
Long: -82.566882452



For more information for your next meeting or event,
call 941-729-9177 or email Meetings@BradentonGulfIslands.com

BradentonGulfIslands.com/Meetings

Real. Authentic. Florida.

Historic Estate



Directions

From Tampa: 40 miles south on I-75 to exit 213 (University Parkway), west to US 41 then right going north on US 41. The entrance is one mile on left side of US 41.

From St. Petersburg: 25 miles south on I-275 over the Skyway Bridge to I075 south to exit 213 (University Parkway), directions are same as above.

From the South: North on I-75 to exit 213 (University Parkway), directions are same as above.



Powel Crosley Estate
8374 North Tamiami Trail, Sarasota, FL 34243
941-722-3244 • PowelCrosleyEstate.com
 See location 10 above, and on area map on back of folder.

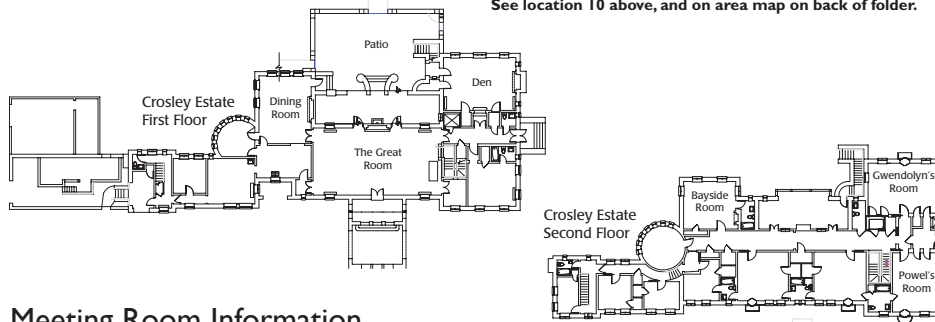

Meeting Room Information

First Floor	Dimension WxL	Area Sq.Ft.	Ceiling Height	Theater Seating	Classroom Seating	Banquet Seating	Boardroom Seating
The Great Room	24' x 44'	1,056	24'	150	60	72	40
Den	18' x 26'	468	12'	40	30	32	25
Dining Room	19' x 24'	456	12'	40	30	32	25

Second Floor	Dimension WxL	Area Sq.Ft.	Ceiling Height	Theater Seating	Classroom Seating	Banquet Seating	Boardroom Seating
Powel's Room	21' x 27'	567	10'	40	30	32	25
Gwendolyn's Room	19' x 26'	494	10'	50	30	40	25
Bayside Room	17' x 18'	306	10'	30	15	24	10

For more information for your next meeting or event, call 941-729-9177 or email Meetings@BradentonGulfIslands.com

BradentonGulfIslands.com/Meetings

Real. Authentic. Florida.